

LinkLITE LinkPRO

Xantrex Battery Monitors



Operating your battery bank without good metering is like running your car without any gauges, although possible to do, it's always better to know how much fuel is left in the tank. Defining the amount of energy available in a battery is a complex task since battery age, discharge current and many other factors influence the actual battery capacity. The LinkLITE uses the same very accurate measurement and calculation systems as the high-end LinkPRO.

The Link Monitors selectively display voltage, charge- and discharge current, consumed amp-hours and remaining battery capacity. Using a clear backlit LCD and an intuitive user interface, all parameters can be recalled with just a button press. A second battery input is also provided to monitor an auxiliary battery (voltage only). A large bargraph delivers instant state of charge information.

The LinkPRO is equipped with an internal programmable alarm relay, to run a generator when needed or to turn off devices when the battery voltage exceed programmable boundaries.

Compared to the LinkPRO, the LinkLITE is a more basic instrument, perfectly suited for users focused on an accurate state of charge readout and very easy setup.

Features

- ◀ Read your battery bank like a fuel gauge
- ◀ Provides critical information about the status of your battery bank
- ◀ Displays voltage, current, consumed amp-hours, remaining battery capacity
- ◀ Time remaining display (LinkPRO only)
- ◀ Two battery inputs (2nd input displays voltage only)
- ◀ Large backlit LC Display
- ◀ Quick nut mounting construction
- ◀ Fully programmable alarm relay (1 contact LinkLITE - 2 contacts LinkPRO)
- ◀ Shunt selection capability enables flexible system integration
- ◀ Communication/expansion port (LinkPRO only)
- ◀ Stores a wide range of history events in internal memory (LinkPRO only)
- ◀ Splash proof frontpanel
- ◀ 500 Amp shunt included
- ◀ CE and e-mark certified
- ◀ 24 month warranty

Applications

- ◀ Recreational vehicles
- ◀ Solar power systems
- ◀ Industrial systems
- ◀ Forklifts
- ◀ Mobile entertainment systems
- ◀ Service vehicles
- ◀ Marine applications
- ◀ Remote homes

Accessories

- ◀ Temperature sensor (LinkPRO only)
- ◀ Isolated RS-232 interface (LinkPRO only)
- ◀ Isolated USB interface (LinkPRO only)
- ◀ 1:5 voltage prescaler (LinkPRO only)
- ◀ 3 pair (1 twisted) monitor cable #200166 (LinkLITE and LinkPRO)

LinkLITE



VOLTAGE
Displays battery voltage to within 0.1V (12 or 24V DC systems)



AMPERE HOURS
Counts and displays the amount of ampere hours removed from the battery (up to 999Ah)



PERCENTAGE REMAINING
Battery % remaining until deepest discharge threshold reached



AMPS
Net charge or discharge current going into or out of the battery bank (up to 500A)

LinkPRO



VOLTAGE
Displays battery voltage to within 0.01V (12 or 24V DC systems)



AMPERE HOURS
Counts and displays the amount of ampere hours removed from the battery (up to 9999Ah)



PERCENTAGE REMAINING
Battery % remaining until deepest discharge threshold reached



AMPS
Net charge or discharge current going into or out of the battery bank



TIME REMAINING
Time remaining in hours & mins until deepest discharge threshold reached



Technical Specifications

Parameter		LinkLITE	LinkPRO
Supply voltage range		9..35VDC	9..35VDC
Supply current ¹⁾ :	@Vin=24VDC	7mA	7mA
	@Vin=12VDC	9mA	9mA
Input voltage range (main battery)		0..35VDC	0..35VDC
Input voltage range (auxiliary battery)		2..35VDC	2..35VDC
Input current range ²⁾		-999..+999A	-9999..+9999A
Battery capacity range		20..999Ah	20..9990Ah
Operating temperature range		-20..+50°C	-20..+50°C
Readout resolution :	voltage (0..35V)	- 0.1V	- 0.01V
	current (0..199A)	- 0.1A	- 0.1A
	current (200..9999A)	- 1A	- 1A
	amphours (0..199Ah)	- 0.1Ah	- 0.1Ah
	amphours (200..9990Ah)	- 1Ah	- 1Ah
	state-of-charge (0..100%)	- 0.1%	- 0.1%
	time remaining (0..24hrs)	N/A	- 1minute
	time remaining (24..240hrs)	N/A	- 1hr
	temperature (-20..+50°C) ³⁾	N/A	- 0.5°C
Voltage measurement accuracy		- 0.3%	- 0.3%
Current measurement accuracy		- 0.4%	- 0.4%
Dimensions :	front panel	fl 64mm	∅ 64mm
	body diameter	fl 52mm	∅ 52mm
	total depth	79mm	79mm
	weight	95gr	95gr
Shunt dimensions :	footprint	45 x 87mm	45 x 87mm
	height	17mm (base) / 35mm (high current screws)	
	weight	145gr	145gr
Protection class		IP20 (frontpanel only IP65)	IP20 (frontpanel only IP65)
Complies with the following standards		EN61000-6-3 (EN55022), EN61000-6-2 (EN61000-2/3/4, EN61000-4-3), LVD 73/23/EEC (EN60335-1), e4-95/54/EC, RoHS 2002/95/EC	

Note: the given specifications are subject to change without notice.

1) Measured with backlight and alarm relay turned off.

2) Depends on selected shunt. With standard delivered 500A/50mV shunt (350A continuous), the range is limited to -600..+600A.

3) Only available when optional temperature sensor is connected.



Dimensions

Sideview :

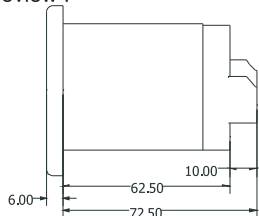

Frontview :

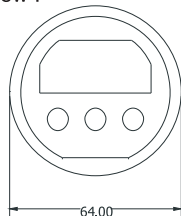

Rearview :

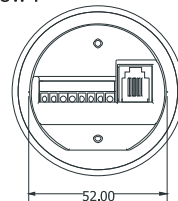

Mounting sequence :

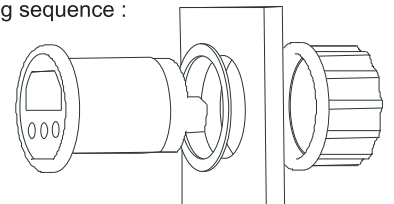

DEALER: