

FUSION

LITHIUM BATTERIES



V-LFP-48-50
LiFePO4 Energy Storage
Deep Cycle Battery
The Future, TODAY!



3 YEAR WARRANTY

Fusion Lithium Batteries deliver **unmatched cycle life** at 100% DOD, **lower cost of ownership** with over 10 years design life and state of the art **BMS technology built in** for the ultimate in **Protection and Safety**

- LiFePO4 chemistry offers the highest and safest power to weight ratio of any Lithium Ion battery
- Half the weight of an equivalent Lead-Acid battery
- Cycles over 1740 times to 100% depth of discharge
- Incredible charge and discharge rates, defying Puckert's Law
- Proudly Australian owned and operated, with local representatives for ideal service
- Built in State of the Art BMS controls cell balancing, over and under voltage protection and short circuit protection
- Housed in completely sealed, water-proof, advanced plastics for durability, performance and heat resistance
- Charge using a regular lead acid charger with float mode that does not have auto rejuvenation or auto pulse
- An immense breakthrough in battery technology Leaves last centuries technology behind!

Applications

- Mobile energy storage; Motor homes, Camper Trailers, Caravans, Yachts, Kayaks and Catamarans
- Lithium Deep Cycle batteries are not suitable for Engine Starting applications
- Renewable and green energy applications
- Can be connected in Series and Parallel for greater storage
- High efficiency charging is well suited for Solar, Wind and Hydro energy storage



To find out more visit our website
www.fusionagmbatteries.com.au



Over-charge and Over-discharge Protection



Short Circuit Protection



Protection against Reversed Connections

Nominal Technical Specifications

Voltage at Full Charge	13.3V
Max. Internal Resistance	<60mΩ
Capacity (Ah, 20Hrs, 0.2C)	50.0Ah
Capacity (Ah, 100Hrs, 0.2C)	52.0Ah
Capacity (Wh, 20Hrs, 0.2C)	2724Wh
Specific Energy	97.3Wh/kg
Energy Density	101Wh/L
Max. Continuous Current	70A
Max. 10 Second Pulse	140A
Short Circuit Current	~410A
Cut off Voltage	9.2V
Cycle Charge Voltage	14.6V
Float Charge Voltage	13.8V
Charge Style	CC/CV*
Min. Charge Current	5.0A
Std. Charge Current	12A
Max. Charge Current	80A
Max. connected in series	2 units
Max. connected in parallel	16 units
Cell Type	Prismatic
Container	FR/ ABS
Length	522mm
Width	238mm
Height	218mm
Volume	27.1L
Weight	28.00kg
Terminal Config.	T11
Max. Terminal Torque	14.6Nm
Terminal Material	Forged Brass
Operating Temperature	-30°C to 60°C
Cycle Life @ 30% D.O.D.	8000 Cycles
Cycle Life @ 50% D.O.D.	2800 Cycles
Cycle Life @ 80% D.O.D.	1900 Cycles
Cycle Life @ 100% D.O.D.	1600 Cycles
Warranty	36 Months

*Any Lead Acid charger with 'float' mode, must not have auto rejuvenation or auto pulse
All technical specifications are measured at 25°C

V-LFP-48-50

Technical Dimensions

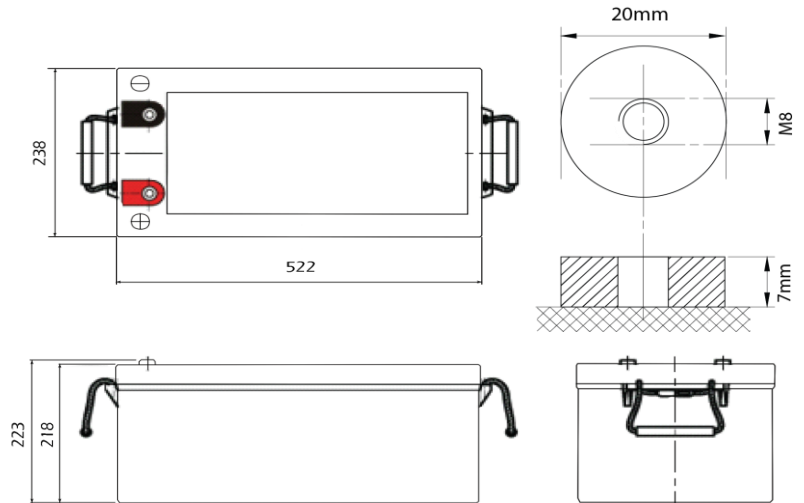

Discharge Performance

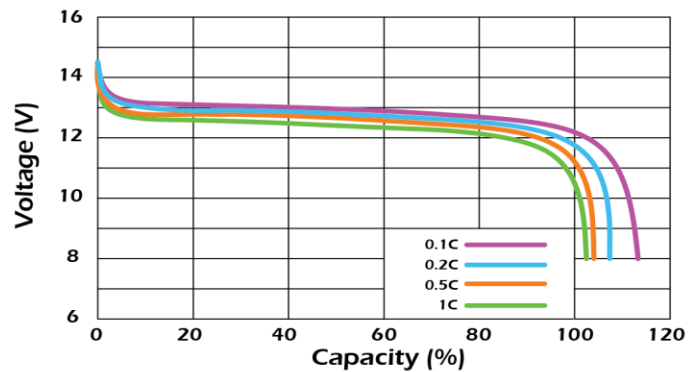

Self-discharge Characteristics

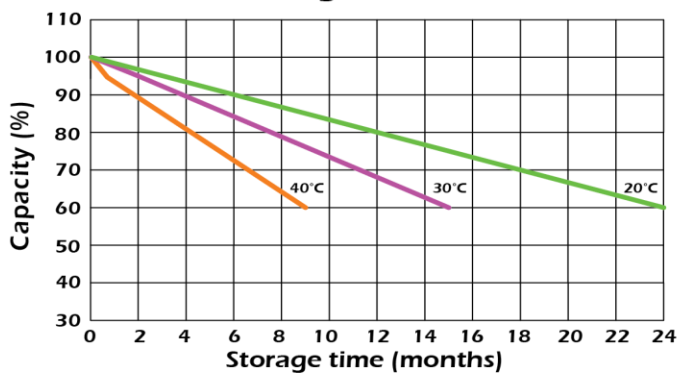

Cycle life in relation to Depth of Discharge

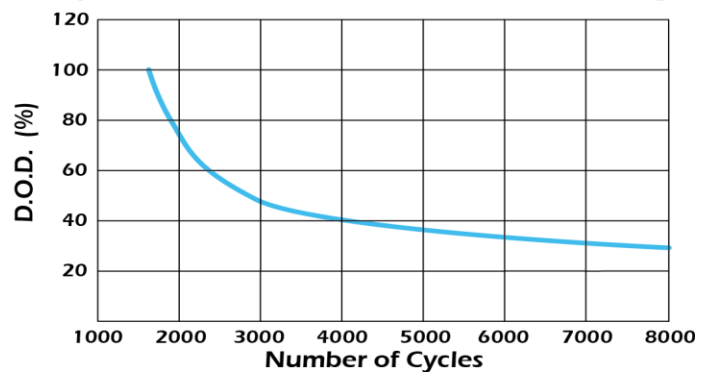

Temperature vs. Capacity

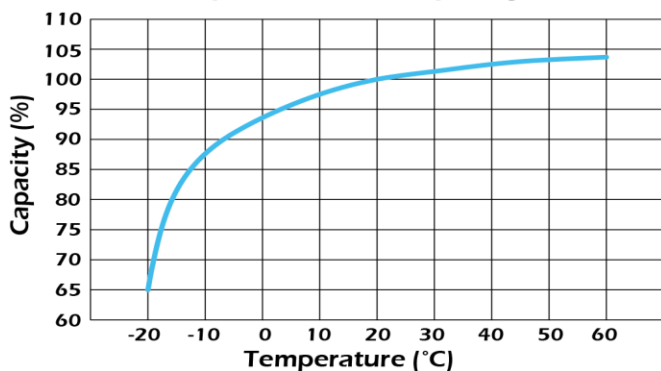

Temperature Vs. Cycle Life

